

SECTION 6: FURNITURE TO BE PLACED ON THE HIGHWAY

5 tables, 10 chairs, 1 A board

Do you intend to alter any of the building and/or frontage to accommodate this proposal?

NO

If YES, please give details:



Fernob Resto 570x570mm
Metal - Colour Storm Grey



Fernob Opera
Metal - Colour Storm Grey



Include for all works necessary to complete the works whether specifically mentioned or not.
 Carry out works in accordance with good working practices unless stated otherwise that are set for that purpose.

Allow for delivering and installing all materials to site as necessary.
 Complete all works in accordance with best industry practice and standards requirements.

Carry out Health & Safety risk assessment of the site and nature of the works and advise designers accordingly of any risk or potential hazards. Carry out all works in accordance with the requirements of the CDM regulations.

Read in conjunction with all drawings and calculate and scope of works

Issue this pre-constructed display counter fittings to be incorporated with depth and appearance of design

Supply and install display storage as indicated on layout drawings

Prepare and describe new partition walls to take into account staff circulation - avoid clutter in the work areas

Include the proposed partitions indicated and indicated as required for fixing of fixtures pending and temporary walls.

Prepare and fabricate workbenches to take into account to work with set board edge detail

Off site area to be described as described above - walls

Contractor shall provide to the client a list of all materials to be supplied to site. Contractor shall be responsible for the supply of all materials to be used on site. Contractor shall be responsible for the supply of all materials to be used on site. Contractor shall be responsible for the supply of all materials to be used on site.

Contractor shall be responsible for the supply of all materials to be used on site. Contractor shall be responsible for the supply of all materials to be used on site. Contractor shall be responsible for the supply of all materials to be used on site.

Contractor shall be responsible for the supply of all materials to be used on site. Contractor shall be responsible for the supply of all materials to be used on site. Contractor shall be responsible for the supply of all materials to be used on site.

Include the works necessary to comply with building regulations.

Rev	Description
Rev 1	Final amendments
Rev 2	Final amendments
Rev 3	Final amendments
Rev 4	Final amendments
Rev 5	Final amendments
Rev 6	Final amendments
Rev 7	Final amendments
Rev 8	Final amendments
Rev 9	Final amendments
Rev 10	Final amendments

MADE IN PLACE

CONSTRUCTION SERVICES

11, 12, 13, 14, 15, 16, 17, 18, 19, 20, 21, 22, 23, 24, 25, 26, 27, 28, 29, 30, 31, 32, 33, 34, 35, 36, 37, 38, 39, 40, 41, 42, 43, 44, 45, 46, 47, 48, 49, 50, 51, 52, 53, 54, 55, 56, 57, 58, 59, 60, 61, 62, 63, 64, 65, 66, 67, 68, 69, 70, 71, 72, 73, 74, 75, 76, 77, 78, 79, 80, 81, 82, 83, 84, 85, 86, 87, 88, 89, 90, 91, 92, 93, 94, 95, 96, 97, 98, 99, 100

Project Name	Griffin Theme
Date	11.10.23
Drawn by	GG
Scale	1:250 @ A2

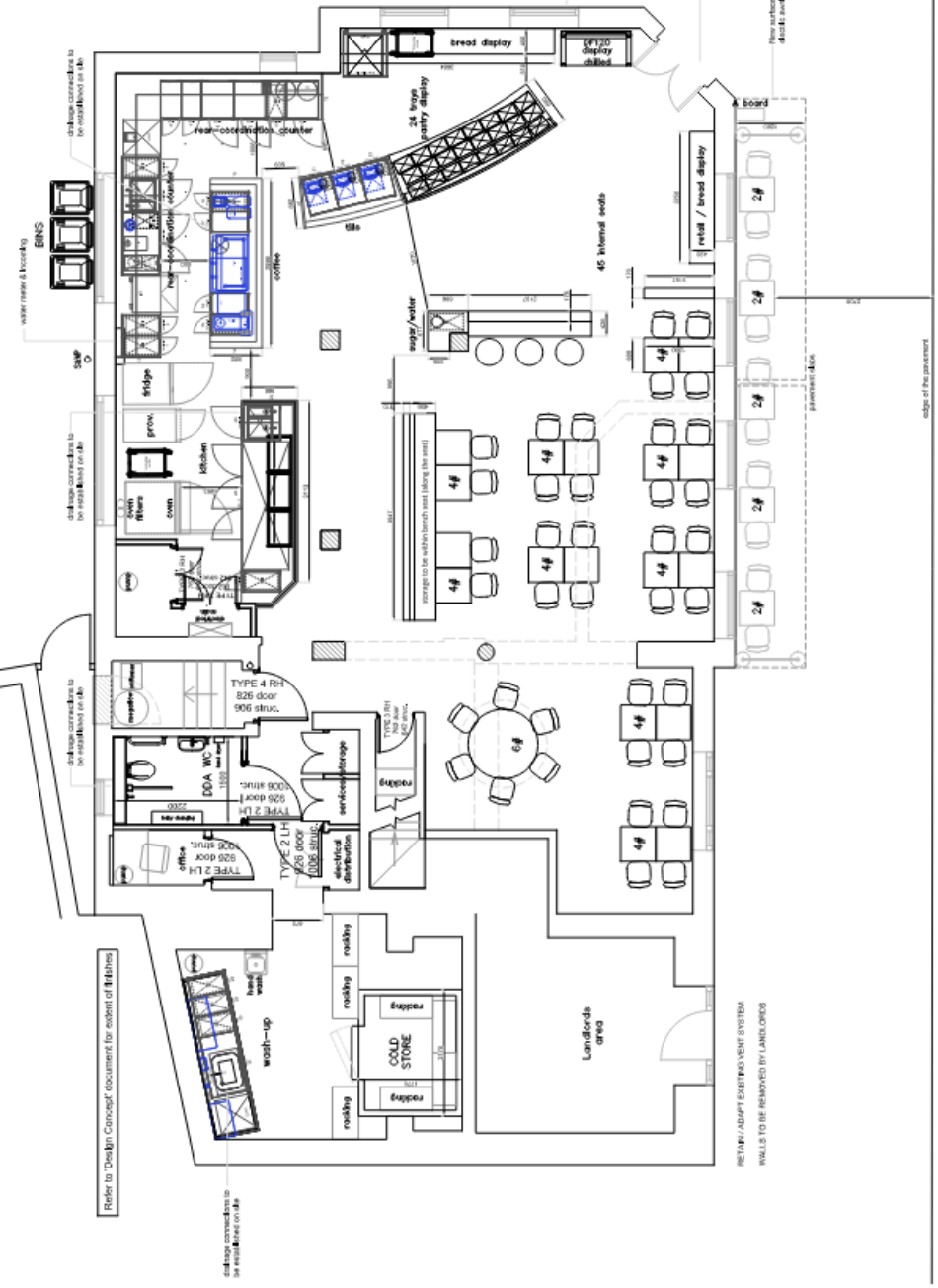

1 PROPOSED GROUND FLOOR PLAN

Scale: 1:250

Supply and install 300x75 panel grade fix doors and frames to openings in walls with complete door covers, thresholds and door casings such as indicated, unless otherwise specified for supplying and installing all

Supply and install 500x75 panel grade fix doors and frames to openings in walls with complete door covers, thresholds and door casings such as indicated, unless otherwise specified for supplying and installing all

Supply and install 100x75 panel grade fix doors and frames to openings in walls with complete door covers, thresholds and door casings such as indicated, unless otherwise specified for supplying and installing all

Supply and install 150x75 panel grade fix doors and frames to openings in walls with complete door covers, thresholds and door casings such as indicated, unless otherwise specified for supplying and installing all

Supply and install 200x75 panel grade fix doors and frames to openings in walls with complete door covers, thresholds and door casings such as indicated, unless otherwise specified for supplying and installing all

Supply and install 250x75 panel grade fix doors and frames to openings in walls with complete door covers, thresholds and door casings such as indicated, unless otherwise specified for supplying and installing all

Supply and install 300x75 panel grade fix doors and frames to openings in walls with complete door covers, thresholds and door casings such as indicated, unless otherwise specified for supplying and installing all

Supply and install 350x75 panel grade fix doors and frames to openings in walls with complete door covers, thresholds and door casings such as indicated, unless otherwise specified for supplying and installing all

Supply and install 400x75 panel grade fix doors and frames to openings in walls with complete door covers, thresholds and door casings such as indicated, unless otherwise specified for supplying and installing all

Supply and install 450x75 panel grade fix doors and frames to openings in walls with complete door covers, thresholds and door casings such as indicated, unless otherwise specified for supplying and installing all

Supply and install 500x75 panel grade fix doors and frames to openings in walls with complete door covers, thresholds and door casings such as indicated, unless otherwise specified for supplying and installing all

Supply and install 550x75 panel grade fix doors and frames to openings in walls with complete door covers, thresholds and door casings such as indicated, unless otherwise specified for supplying and installing all

Supply and install 600x75 panel grade fix doors and frames to openings in walls with complete door covers, thresholds and door casings such as indicated, unless otherwise specified for supplying and installing all

Supply and install 650x75 panel grade fix doors and frames to openings in walls with complete door covers, thresholds and door casings such as indicated, unless otherwise specified for supplying and installing all

Supply and install 700x75 panel grade fix doors and frames to openings in walls with complete door covers, thresholds and door casings such as indicated, unless otherwise specified for supplying and installing all

Supply and install 750x75 panel grade fix doors and frames to openings in walls with complete door covers, thresholds and door casings such as indicated, unless otherwise specified for supplying and installing all

Supply and install 800x75 panel grade fix doors and frames to openings in walls with complete door covers, thresholds and door casings such as indicated, unless otherwise specified for supplying and installing all

Supply and install 850x75 panel grade fix doors and frames to openings in walls with complete door covers, thresholds and door casings such as indicated, unless otherwise specified for supplying and installing all

Supply and install 900x75 panel grade fix doors and frames to openings in walls with complete door covers, thresholds and door casings such as indicated, unless otherwise specified for supplying and installing all

Supply and install 950x75 panel grade fix doors and frames to openings in walls with complete door covers, thresholds and door casings such as indicated, unless otherwise specified for supplying and installing all

Supply and install 1000x75 panel grade fix doors and frames to openings in walls with complete door covers, thresholds and door casings such as indicated, unless otherwise specified for supplying and installing all

