

Key

- Location of Informal Disabled Persons Parking Place to be made formal
- Proposed Disabled Persons Parking Place

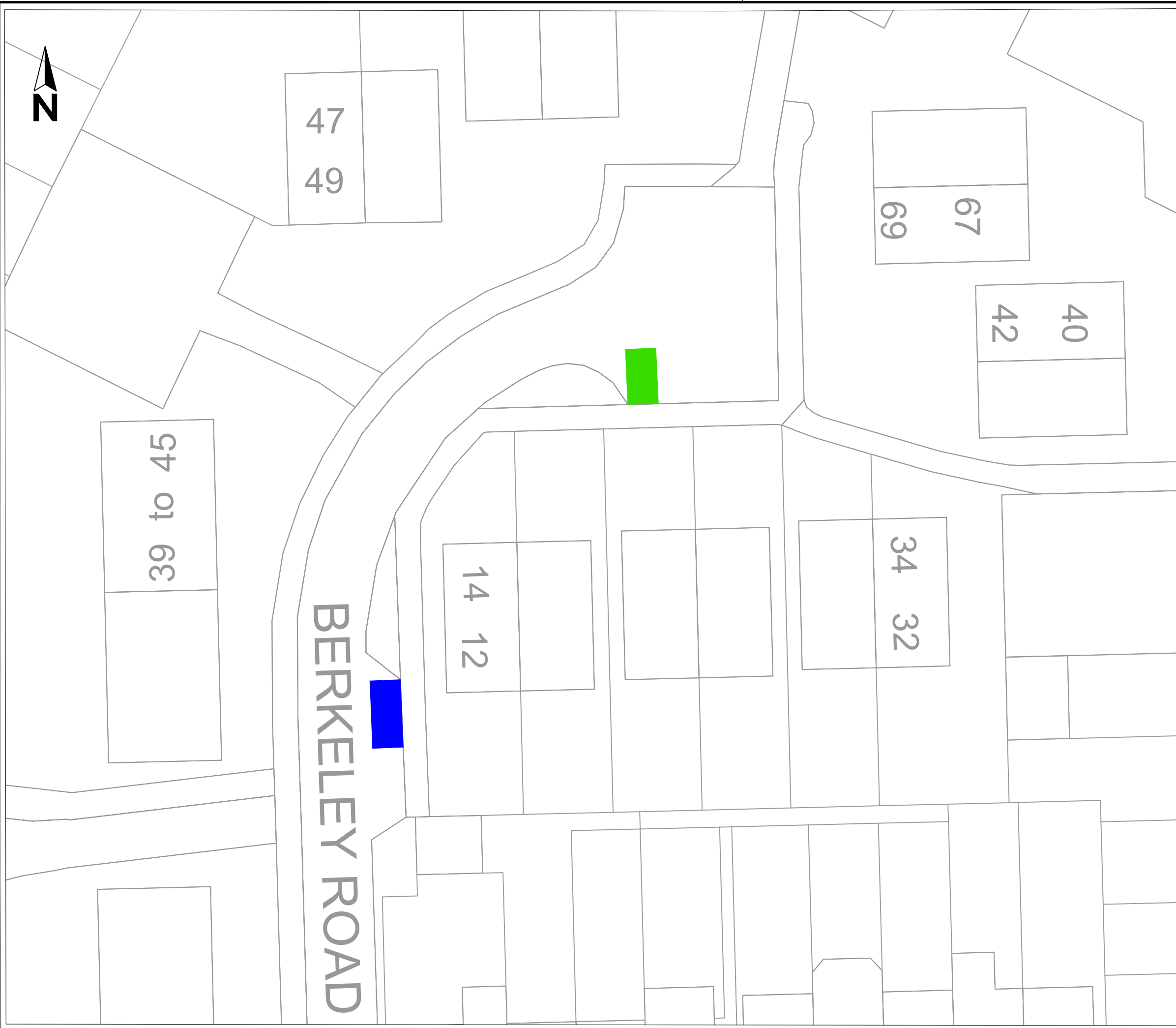

Reproduced from the Ordnance Survey mapping with the permission of the Controller of Her Majesty's Stationery Office © Crown Copyright. Unauthorised reproduction infringes Crown Copyright, and may lead to prosecution or civil proceedings. Oxfordshire County Council Licence No LA076805

Rev.	Date	Purpose of revision	Drawn	Checked	Approved

OXFORDSHIRE COUNTY COUNCIL

Bill Cotton
Corporate Director for Environment and Place
Communities
Oxfordshire County Council
County Hall
Oxford
OX1 1ND
Tel: 0345 310 11 11
Fax: (01865) 241577

Project title

DISABLED PERSONS PARKING PLACE PROPOSALS

Drawing title

THAME BERKELEY ROAD

Drawing Status

Scale @ A3	Drawn by	Checked by	Approved by
N.T.S.	JaC		
	Date drawn 10/22	Date checked	Date approved